

Customer-specific linear guide from SIMG®

for
 Contact person:
 Customer:
 Phone:
 E-mail:

Quantity: / / / / pieces ∞

Dimensions	Type1	Type1K	Type2	Type3
Measure A:		mm		
Measure B:		mm		
Measure C:		mm		
Measure D:		mm		
Measure E:		mm		
Measure F:		mm		

Conditions at the depository

Speed: r.p.m
 Capacity axial stat: N
 Capacity axial dyn: N
 Speed: m/s

Operation temperature: °C
 Conductibility or insulation resp.: yes Atex no
 Weatherability: yes no
 Food conformity: yes no
 Radiation exposure/resistance: kGy
 Chemical additives :

Material selection

Housing:
 Cage:
 Balls:

Type 1
 ball bearing mounted,
 adjustable,overhead

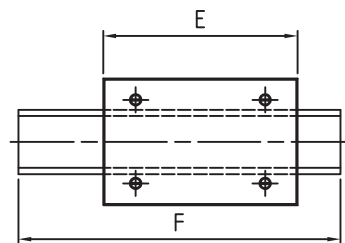
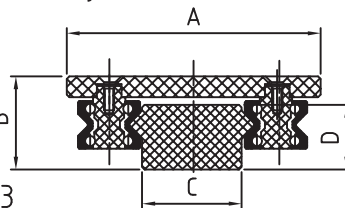

Type 1K
 ball bearing mounted,
 adjustable,overhead
 suitable for curve drives

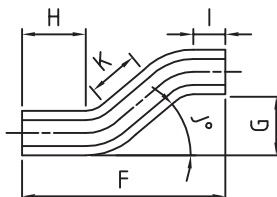
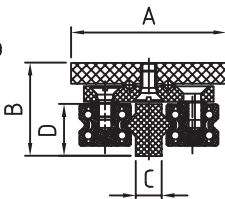

Type 2
 ball bearing mounted

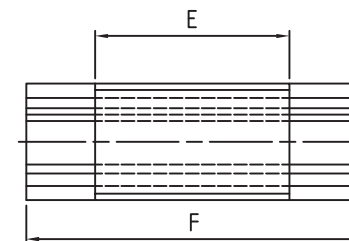
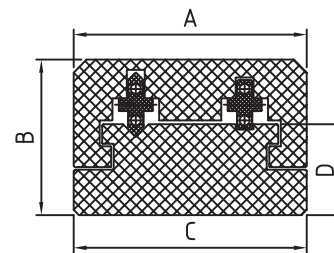

Type 3
 rolling convoy storage

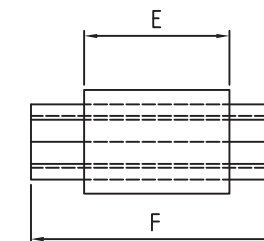
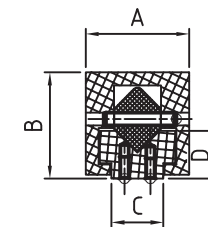

Schmeing GmbH & Co. KG
 46348 Raesfeld-Tel.02865/909300